

AUTOMATED HIGH PRESSURE BALL VALVE

BILL OF MATERIALS

PART #	NAME	MATERIAL	OPTIONAL MATERIAL	QTY
1	BODY	CARBON STEEL	CARBON STEEL	1
2	BALL	CARBON STEEL	STAINLESS STEEL	1
3	SPINDLE	CARBON STEEL	STAINLESS STEEL	1
4	BALL SEAT	DELRIN	C/F	2
5	END CONNECTIONS	CARBON STEEL	STAINLESS STEEL	2
6	O-RING	BUNA-N	C/F	2
7	THRUST WASHER	DELRIN	C/F	1
8	SPINDLE O-RING	BUNA-N	C/F	1
9	EXTERNAL GLIDE WASHER	DELRIN	C/F	1
10	STOP PIN	CARBON STEEL	STAINLESS STEEL	1
11	STOP WASHER	CARBON STEEL	STAINLESS STEEL	1
12	COLOR CODED TOP CAP	ALUMINUM	N/A	1
13	TOP CAP SCREW	CARBON STEEL	STAINLESS STEEL	1
14	HANDLE	ALUMINUM	N/A	1

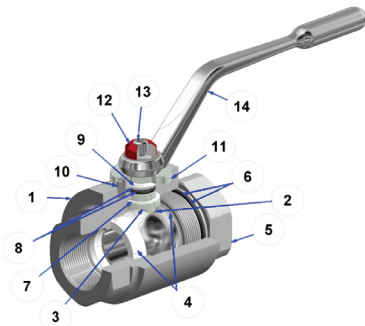

VALVE FEATURES

- Full port carbon or stainless steel ball valve 1/4" through 4"
- NPT, SAE or split flange
- Delrin seats/BUNA seals
- 6000 PSI pressure rated
- drilled and tapped mounting pad

PRESSURE RATING
6000 PSI (carbon steel)
6000 PSI 1/4" through 3/4" in SS; 3000 PSI 1" through 4"

TEMPERATURE RATING
+400° F Maximum CWP
-60° F Minimum

NOTE: Maximum temperature rating for standard actuators is 150° F (electric) and 180° (pneumatic). Special seals or heat extensions are available for high temperature service.

For more information on BI-TORQ® actuators, please refer to brochures PN-2007 and EL-2008, or www.bitorq.com

ACTUATOR FEATURES

- PNEUMATIC ACTUATORS**
- Rack and pinion design
 - Spring return or double acting
 - open and closed adjustment stops
 - true NAMUR accessory mounting
 - visual indicator

- ELECTRIC ACTUATORS**
- 120VAC, 220VAC, 24VAC, 12VDC, 24VDC
 - NEMA 4 and NEMA 7 enclosures
 - Manual override
 - visual indicator

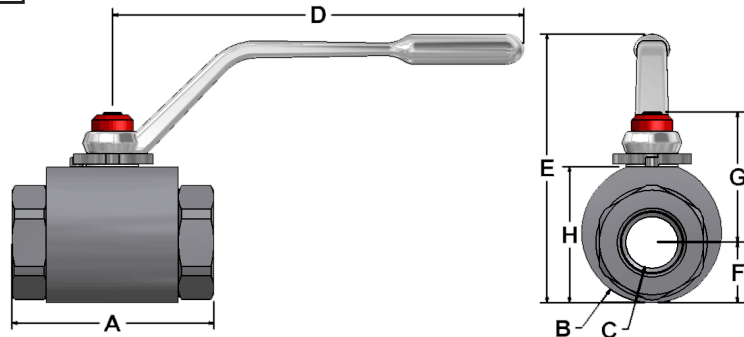

DIMENSIONAL DATA (WITH NPT ENDS)

SIZE	A	B	C	D	E	F	G	H	PSI*	WEIGHT (LBS.)
1/4"	2.74	1.38	0.31	4.50	2.99	0.61	1.38	1.38	6000	1.08
3/8"	2.87	1.50	0.38	4.50	3.12	0.64	1.50	1.50	6000	1.42
1/2"	3.36	1.63	0.50	4.50	3.25	0.73	1.63	1.63	6000	1.80
3/4"	3.81	2.25	0.75	7.00	4.73	1.00	2.25	2.25	6000	4.24
1"	4.51	2.50	0.94	7.00	4.98	1.14	2.50	2.50	6000	5.50
1-1/4"	4.84	3.38	1.25	9.85	6.45	1.45	3.26	3.38	6000	5.80
1-1/2"	5.33	3.75	1.50	9.85	6.82	1.64	3.64	3.75	6000	6.04
2"	6.54	4.50	1.88	9.85	7.49	2.01	4.30	4.50	6000	18.58
2-1/2"	7.50	6.94	2.50	14.50	10.24	3.29	6.61	6.94	6000	C/F
3"	9.29	7.50	3.00	14.50	12.64	4.35	8.37	7.50	6000	C/F
4"	11.21	9.94	4.00	20.00	15.31	5.77	10.94	9.94	6000	C/F

* WITH STANDARD SEATS AND CARBON STEEL BODY