

IZ-SERIES 2-PIECE BRONZE BALL VALVES

BILL OF MATERIALS

| PART # | NAME | MATERIAL | QTY |
|--------|---------------|---------------------|-----|
| 1 | BODY | BRONZE | 1 |
| 2 | BALL | CHROME PLATED BRASS | 1 |
| 3 | STEM PACKING | PTFE | 1 |
| 4 | PACKING GLAND | BRASS | 1 |
| 5 | STEM* | BRASS* | 1 |
| 6 | SEAT BACKING | EPDM | 1 |
| 7 | BALL SEAT | PTFE | 2 |
| 8 | STEM SEAL | PTFE | 1 |
| 9 | O-RING | BUNA-N | 2 |
| 10 | MOUNTING PAD | BRONZE | 1 |

*Stainless Steel on 2-1/2" and 3"

VALVE FEATURES

- Full port bronze valve 1/4" through 3"
- TFE® seats with EPDM backing
- BUNA-N stem o-rings
- ISO mounting pad
- blowout proof stem
- fully vacuum rated
- manual handle option

PRESSURE RATING
600 WOG

TEMPERATURE RATING
+297°F Maximum

NOTE: Maximum temperature rating for standard actuators is 150°F (electric) and 180°F (pneumatic). Special seals or heat extensions are available for high temperature service.

For more information on BI-TORQ® actuators, please refer to brochures PN-2007 and EL-2008, or www.bitorq.com

ACTUATOR FEATURES

PNEUMATIC ACTUATORS

- Rack and pinion design
- Spring return or double acting
- open and closed adjustment stops
- true NAMUR accessory mounting
- visual indicator

ELECTRIC ACTUATORS

- 120VAC, 220VAC, 24VAC, 12VDC, 24VDC
- NEMA 4 and NEMA 7
- Manual override
- visual indicator

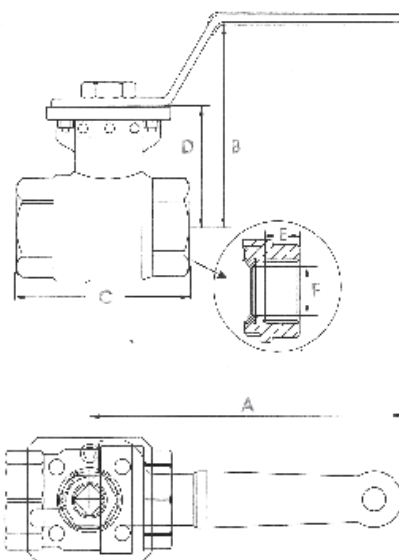
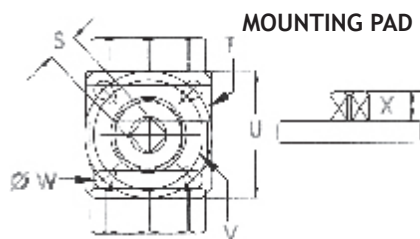
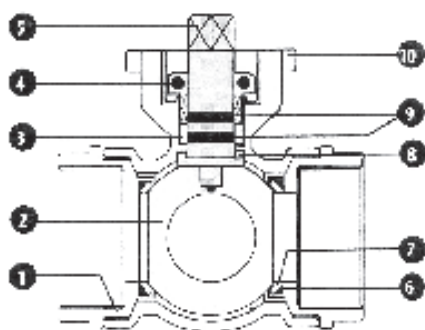

| SIZE | CV | WT. | TORQUE |
|--------|-----|------|--------|
| 1/4" | 6 | 0.68 | 30 |
| 3/8" | 9 | 0.68 | 30 |
| 1/2" | 13 | 0.68 | 35 |
| 3/4" | 27 | 0.78 | 41 |
| 1" | 49 | 0.82 | 53 |
| 1-1/4" | 114 | 0.91 | 87 |
| 1-1/2" | 161 | 1.35 | 125 |
| 2" | 249 | 2.22 | 135 |
| 2-1/2" | 503 | 3.17 | 274 |
| 3" | 734 | 5.48 | 430 |

DIMENSIONAL DATA

| SIZE | ISO 5211 | A | B | C | D | E | F | S | T | U | V | W | X |
|--------|----------|------|------|------|------|------|------|-------|------|------|------|-----------|------|
| 1/4" | F03/F04 | 4.92 | 1.95 | 2.50 | 1.59 | 0.66 | 0.39 | 0.354 | 1.65 | 1.65 | 1.41 | 0.24 | 0.33 |
| 3/8" | F03/F04 | 4.92 | 1.95 | 2.50 | 1.59 | 0.66 | 0.39 | 0.354 | 1.65 | 1.65 | 1.41 | 0.24 | 0.33 |
| 1/2" | F03/F04 | 4.92 | 2.81 | 2.50 | 1.65 | 0.66 | 0.59 | 0.354 | 1.65 | 1.65 | 1.41 | 0.24 | 0.33 |
| 3/4" | F03/F04 | 4.92 | 3.08 | 2.50 | 1.94 | 0.58 | 0.75 | 0.354 | 1.65 | 1.65 | 1.41 | 0.24 | 0.41 |
| 1" | F04/F05 | 5.51 | 3.21 | 3.15 | 2.07 | 0.69 | 0.98 | 0.433 | 1.97 | 1.97 | 1.65 | 0.24/0.26 | 0.47 |
| 1-1/4" | F04/F05 | 5.51 | 3.41 | 3.58 | 2.28 | 0.73 | 1.26 | 0.433 | 1.97 | 1.97 | 1.65 | 0.24/0.26 | 0.40 |
| 1-1/2" | F05/F07 | 6.89 | 4.19 | 3.96 | 2.81 | 0.77 | 1.50 | 0.433 | 2.76 | 2.76 | 1.97 | 0.26/0.33 | 0.61 |
| 2" | F05/F07 | 6.89 | 4.55 | 4.84 | 3.17 | 0.80 | 1.97 | 0.551 | 2.76 | 2.76 | 1.97 | 0.26/0.33 | 0.70 |
| 2-1/2" | F07 | --- | --- | 6.18 | 3.42 | 1.19 | 2.56 | 0.551 | --- | 2.76 | 2.76 | 0.35 | 0.59 |
| 3" | F07 | --- | --- | 7.32 | 3.85 | 1.31 | 2.99 | 0.551 | --- | 2.76 | 2.76 | 0.35 | 0.59 |