

# BI-TORQ AL-SERIES DIMENSIONAL DATA

FOR ACTUATOR MODELS 45 THROUGH 350

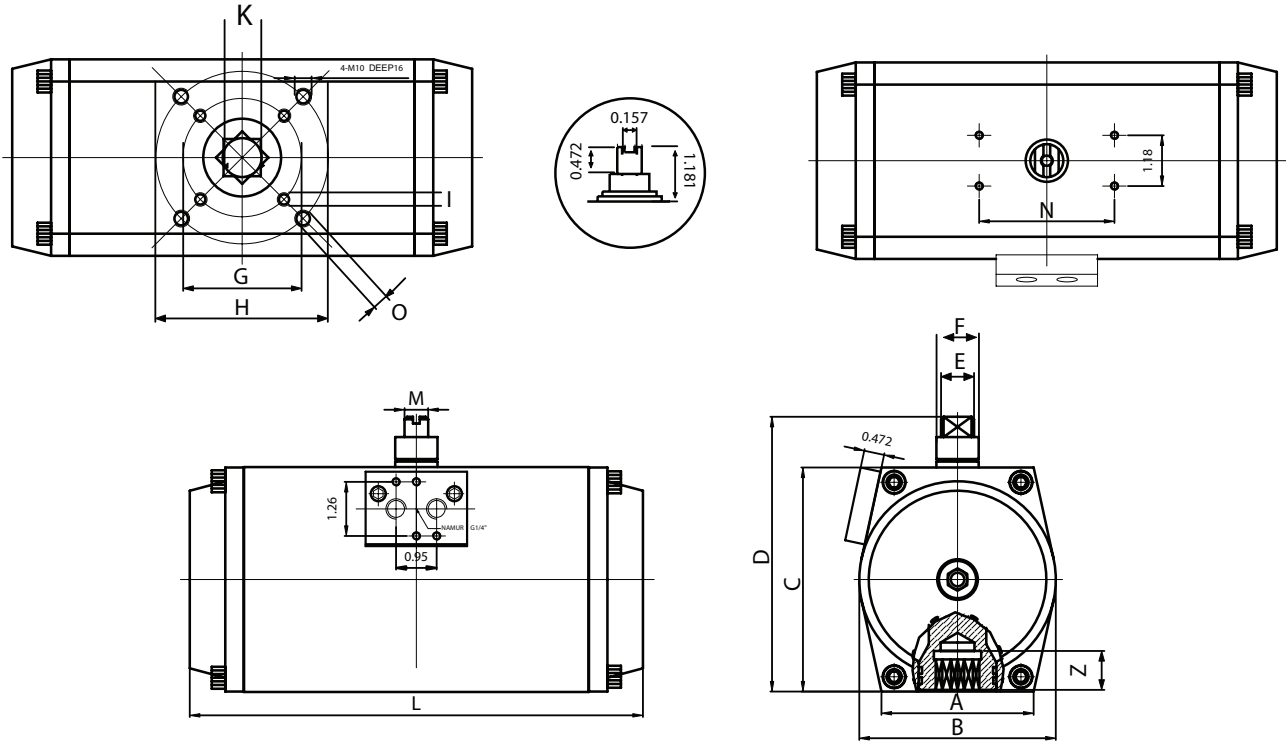

## DIMENSIONAL DATA

	ISO 5211	A	B	C	D	E	F	G	H	I	K	L	M	N	O	Z	AIR CONNECTION
AL-45	F03/F05	1.89	2.28	2.56	3.74	0.47	0.55	1.42	1.97	M5 x 8	0.433	5.75	0.39	3.15	M6 x 10	0.55	1/8"
AL-52	F03-F05	1.97	2.32	2.91	4.09	0.47	0.55	1.42	1.97	M5 x 8	0.433	5.75	0.39	3.15	M6 x 10	0.55	1/8"
AL-63	F05/F07	2.36	2.83	3.46	4.65	0.47	0.71	1.97	2.76	M6 x 10	0.551	6.61	0.39	3.15	M8 x 13	0.71	1/8"
AL-75	F05/F07	2.56	3.27	3.94	5.12	0.47	0.71	1.97	2.76	M6 x 10	0.551	7.24	0.39	3.15	M8 x 13	0.71	1/8"
AL-83	F05/F07	2.64	3.54	4.29	5.47	0.55	0.71	1.97	2.76	M6 x 10	0.669	8.03	0.39	3.15	M8 x 13	0.83	1/8"
AL-92	F05-F07	2.99	4.09	4.72	5.91	0.71	0.98	1.97	2.76	M6 x 10	0.669	10.24	0.55	3.15	M8 x 13	0.83	1/8"
AL-105	F07/F10	3.54	4.53	5.24	6.42	0.79	0.98	2.76	4.02	M8 x 13	0.866	10.55	0.55	3.15	M10 x 16	1.02	1/8"
AL-125	F07/F10	4.09	5.51	6.10	7.28	1.10	1.57	2.76	4.02	M8 x 13	0.866	11.73	0.79	5.12	M10 x 16	1.02	1/4"
AL-140	F10/F12	4.21	5.98	6.75	7.93	1.10	1.57	4.02	4.92	M10 x 16	1.063	15.35	0.79	5.12	M12 x 20	1.22	1/4"
AL-160	F10/F12	5.04	6.92	7.76	8.94	1.42	1.57	4.02	4.92	M10 x 16	1.063	18.03	1.10	5.12	M12 x 20	1.22	1/4"
AL-190	F14	5.31	8.11	9.06	10.24	1.77	2.36	---	5.51	---	1.417	20.67	1.26	5.12	M16 x 25	1.57	1/4"
AL-210	F14	5.31	8.90	10.04	11.22	1.77	2.36	---	5.51	---	1.417	20.94	1.26	5.12	M16 x 25	1.57	1/4"
AL-240	F16	6.10	10.08	11.42	12.60	1.77	2.36	---	6.50	---	1.811	23.70	1.26	5.12	M20 x 25	1.97	1/4"
AL-270	F16	7.48	11.57	12.60	13.78	1.77	2.36	---	6.50	---	1.811	28.43	1.26	5.12	M20 x 25	1.97	1/2"
AL-300	F16	7.72	12.76	13.70	14.88	1.77	2.36	---	6.50	---	1.811	29.21	1.26	5.12	M20 x 25	2.36	1/2"
AL-350	F16	8.66	14.96	15.83	17.01	1.77	2.36	---	6.50	---	1.811	33.86	1.26	5.12	M20 x 25	2.36	1/2"

Special mounting patterns and pinion output shafts are available upon request. In addition, AVK Carbo-Bond can manufacture customized mounting hardware, extensions and specialty linkages to adapt the AL-Series pneumatic actuator to a variety of valves and applications.