

M-200TS Recessed Wall Box

Strahman's recessed mixing units are designed to conceal mixing unit piping in a stainless steel box for recessed wall mounting. All exposed parts are either bronze chrome-plated or stainless steel depending on the selected unit. These units are ideal for new construction or other places where concealed piping and good looks are desirable.

The Thermostatically Controlled Hot and Cold Water Mixing Unit features high quality and rugged construction. The unit's accurate, solid, liquid-filled thermostat allows you to set the exact output of water temperature desired from cold to 160°F. Featuring durable bronze body construction with replaceable corrosion-resistant components, the **M-200TS** valve maximizes cleaning effectiveness for any application. Both the piston and liner are made of stainless steel for long-lasting reliability.



Specifications

- ◆ Integral one button shut-off: Pull on and push off
- ◆ Precise temperature control from cold to 110°F to 160°F in this instance (There is a 50° difference from maximum temperature to cool water.)
- ◆ Adjustable temperature limit stop for operator safety
- ◆ Replaceable components facilitate service
- ◆ Optional compressed air outlet

NOTE: 1-year warranty

Please see reverse side for parts listing.

Shown: Recessed Series with **M-200TS** unit; shown with premium hose assembly and **S-70 Series** nozzle



USA Headquarters

2801 Baglyos Circle ♦ Bethlehem, PA 18020

Phone: (484) 893-5080 ♦ Fax: (484) 893-5099 ♦ Toll Free: (877) STRAHMAN

www.strahmanvalves.com

France

Savoie Hexapole, F-73420 Mery, France

Tel: 33 (0) 4 79 35 78 00

Fax: 33 (0) 4 79 35 78 20

Germany

Kirchstrasse 16, D-77855, Achern, Germany

Tel: 49 (0) 7841-6846530

Fax: 49 (0) 7841-6846531



ISO 9001
QMI-SAI Global

Last Updated: July, 2012

M-200TS Recessed Wall Box

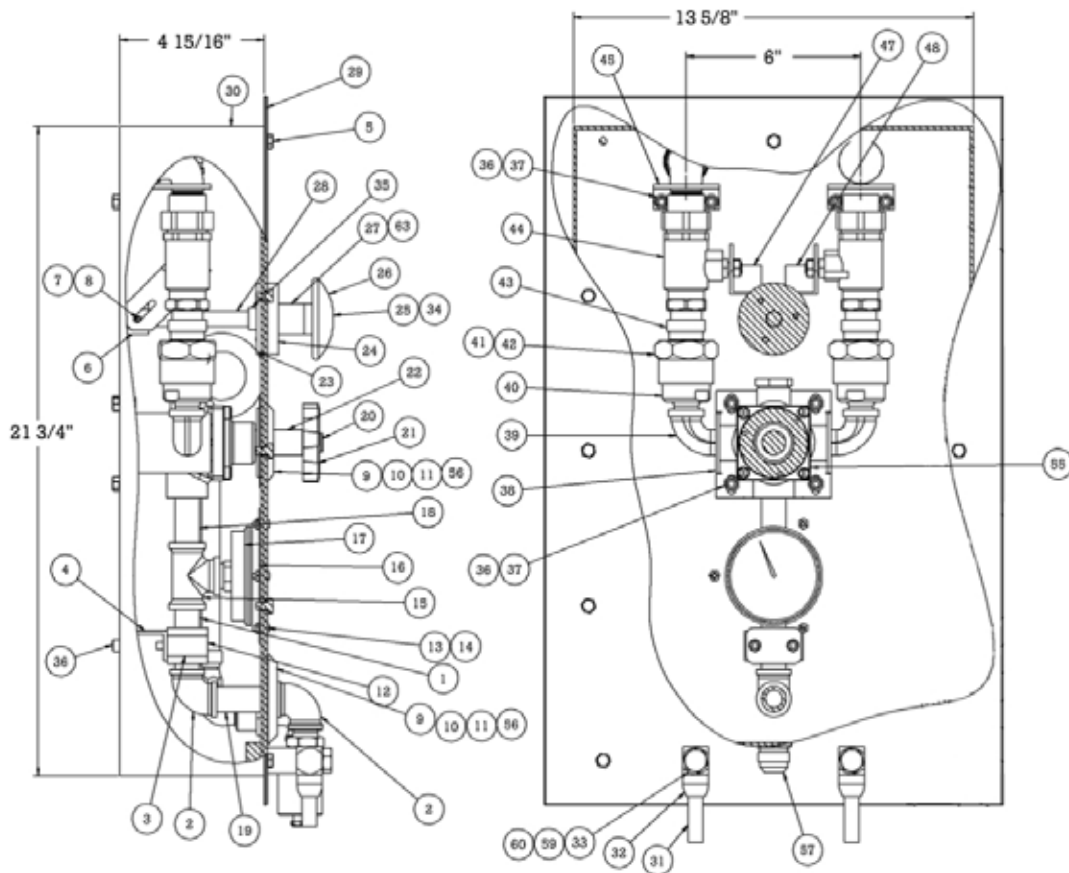

PARTS

PART NO.	DESCRIPTION	PART NO.	DESCRIPTION	PART NO.	DESCRIPTION
1	½ NIPPLE 3 BRASS	19	½ X 3" LONG NIPPLE SST	37	¼ WASHER
2	½ ELBOW BRASS	20	5/16-24 X 2" FLAT HEAD SST	38	VALVE BRACKET
3	½" PIPE SUPPORT	21	CONTROL KNOB	39	½ STREET ELBOW BRASS
4	PIPE SUPPORT SPACER	22	CONTROL EXTENSION	40	ADAPTER
5	¼-20 X ¾ BOLT SST	23	STEM SLEEVE RETAINER	41	BALL CHECK NUT
6	STEM NUCKEL	24	10-32 X ¾ FLAT HEAD	42	BALL CHECK GASKET
7	CLEVIS PIN	25	¼-20 X ¾ FLAT HEAD	43	BALL CHECK
8	NO. 10 WASHERS	26	PALM KNOB	44	BALL VALVE
9	ESCUTCHON PLATE	27	STEM SLEEVE	45	BRACKET
10	8-32 X 3/16 PAN HD SCR	28	STEM ROD	47	LINKAGE ARM LEFT
11	CLIP	29	COVER	48	LINKAGE ARM RIGHT
12	¼-20 X 1 ¾ LONG SHCS	30	BOX	55	MIXING VALVE
13	8-32 X 3/8 PAN HEAD SST	31	HOSE RACK	56	3/8 HOSE BARB
14	8-32 X NUT SST	32	HOSE RACK CONNECTOR	57	UNIT END ADAPTER
15	½ TEE BRASS	33	½-13 X ½ LONG BOLT	58	COTTER PIN
16	LENZ	34	FINISH WASHER	59	HOSE RACK SPACER
17	TEMPERATURE GAUGE	35	BUMPER	60	½ STAR WASHER
18	½ X 2½" NIPPLE BRASS	36	¼-20 X ½ SHCS SST	63	BRONZE BEARING